

QUICK-START GUIDE

Evergreen Mag · 3,000 mAh

What's in the Box

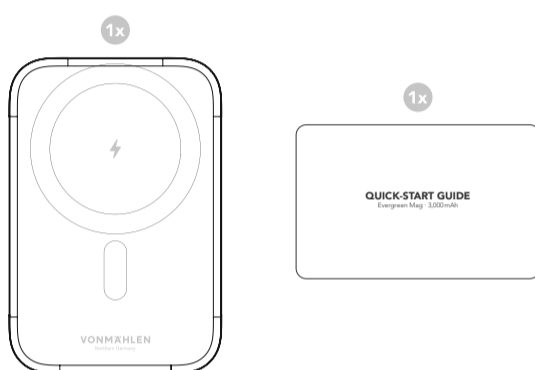

Functions

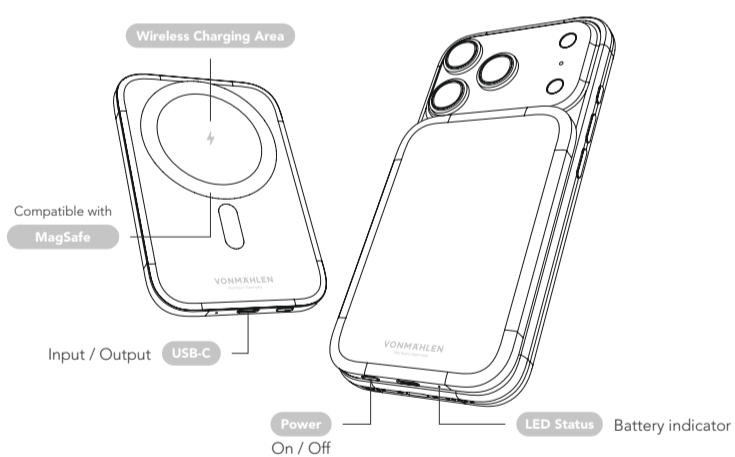

Scan the QR-code for
more product information
or for other languages.



Application

Charging

the magnetic power bank

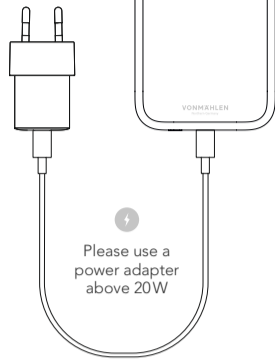

Charging

the phone via USB-C cable

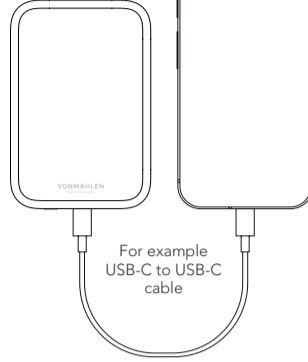

Wireless Charging

Place your phone on the inductive charging surface.

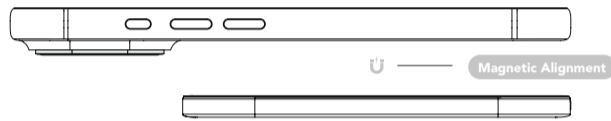

LED Status Wireless charging indicator

✧ The green LED lights up when the power bank is charging wirelessly.

Remove the phone:

The indicator light turns off after 5 seconds, and the product shuts down after 35 seconds.

Foreign Object Detection:

The red indicator light flashes rapidly for 10 seconds, then turns off and the product shuts down.



Wireless charging indicator (green) LED Status

LED States



0% - 5%



Red light flashes

5% - 20%



Red light turns on

20% - 100%



Green light turns on

LED Status Battery indicator (green/red)

Tech Specs

Battery Type	Integrated Rechargeable Lithium Polymer Battery
Battery Capacity	3,000mAh / 3.85V / 11.55Wh
Rated Capacity	1,800mAh (5V=1A)
USB-C Port (Input)	5V=2A, 9V=2.22A
USB-C Port (Output)	5V=2A
Wireless Charging (Output)	7.5W (Max.)
Product Size	L 104.4 × W 70.4 × H 5.8mm
Weight	83.4g

We reserve the right to make changes without notice in the interest of technical progress.